



Order Code: PT104

House Plan **56969**

The foyer and oversized great room with raised ceilings and cozy gas logs greet you when you enter.

Total Living Area	1,600 sq.ft
Main Level	1,600 sq.ft
Bedrooms	3
Bathrooms	2.5
Garage Type	2 Bay
Dimensions	47' Wide x 65' Deep

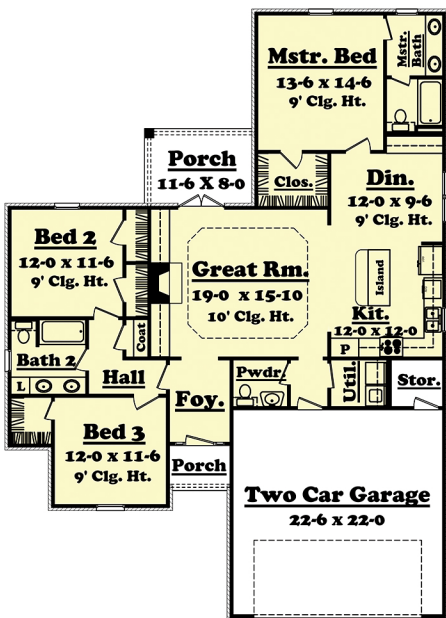

familyhomeplans.com